

THUMPER JOCKEY CRUSADER

Install the wire harness:

This kit is designed to draw power from the bike's battery. Route the wire harness from the battery to the front of the motorcycle behind the number plate. In most cases the wire harness will need to be routed under the gas tank. Keep the wire harness away from pinch points and the engine/exhaust. Use zip ties when necessary to keep the harness from moving.

The Red wire will need to be attached to the + positive side of the battery.
The Black wire will need to be attached to the - negative side of the battery.

*Do not ground the black wire to the frame. It must be connected to the battery.

Install the switch:

The switch is designed to mount to the clutch perch or the front brake master cylinder using your existing bolts (figure 1). Use zip ties to keep the wires tight to the handlebars.

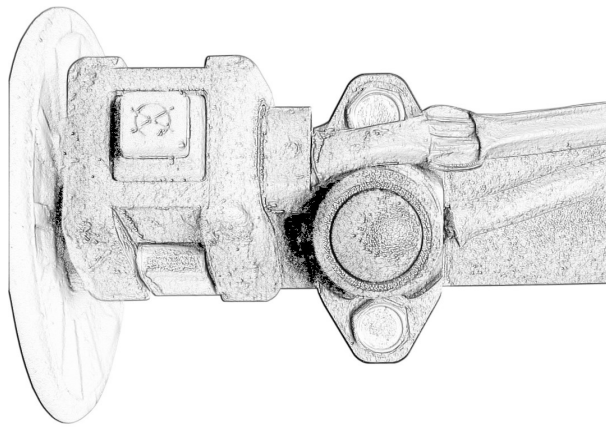

(figure 1)

Install the lights:

The light mounts are designed to fit around the upper fork tube (Figure 2). Use the rubber strip between the fork tube and the clamp to prevent slipping and damage to the fork tube.

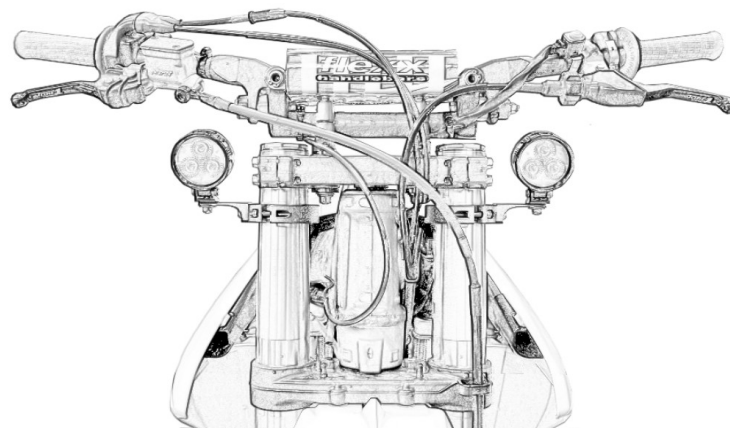

(figure 2)

Light assembly:

The lights should be assembled as shown in (figure 3).

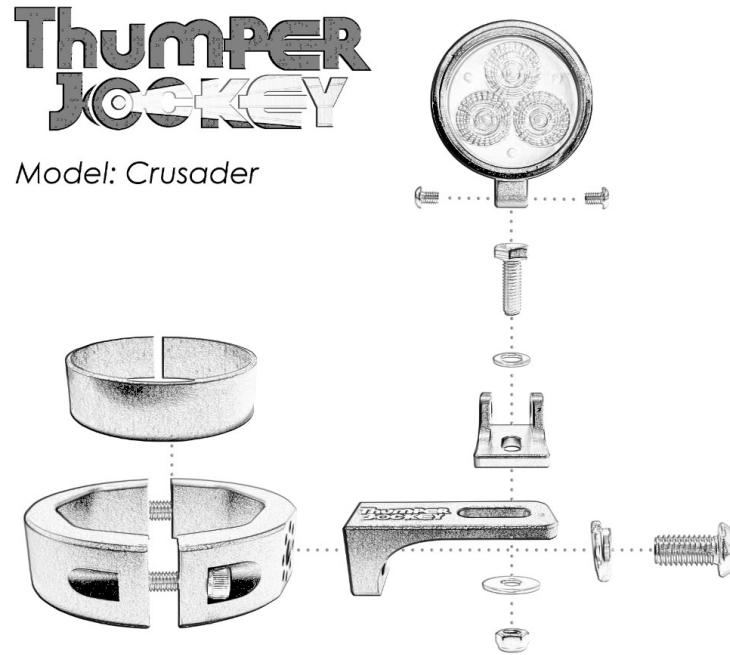

(figure 3)

For additional questions please email Thumper Jockey at ThumperJockey@gmail.com